



SOFT JAW LOCATOR

OWNER'S MANUAL

THE SOFT JAW LOCATOR IS DESIGNED TO QUICKLY AND ACCURATELY POSITION SOFT JAWS DURING INSTALLATION. USING THE PROCEDURE BELOW WILL ENSURE THAT THE SOFT JAWS WILL BE INDEXED THE SAME WAY EACH TIME THEY ARE USED.

NOTES:

- THE FOLLOWING PROCEDURE NEEDS TO BE PERFORMED ON NEW SOFT JAWS BEFORE ANY MACHINING IS DONE.
- THE SOFT JAW LOCATOR WILL ONLY WORK WITH SOFT JAWS THAT ARE FLAT AND SQUARE ON AT LEAST ONE END. SOFT JAWS WITH SAW CUT ENDS WILL NOT WORK WITH THIS TOOL.

STEP 1

- MOUNT A SOFT JAW TO THE MOVABLE SIDE OF THE VISE AS SHOWN.

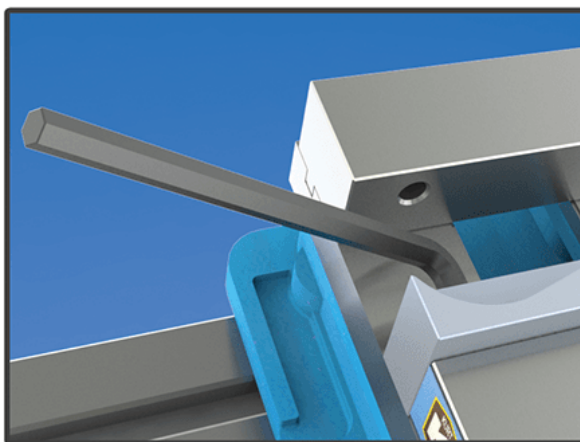

STEP 2

- TIGHTLY CLOSE THE VISE.
- INSTALL THE SOFT JAW LOCATOR AS SHOWN. IT CAN BE MOUNTED ON THE OPPOSITE SIDE OF THE VISE IF NEEDED.

STEP 3

- POSITION THE STOP ROD AGAINST THE SOFT JAW AS SHOWN. TIGHTEN THE THUMB SCREWS ON THE SOFT JAW LOCATOR.

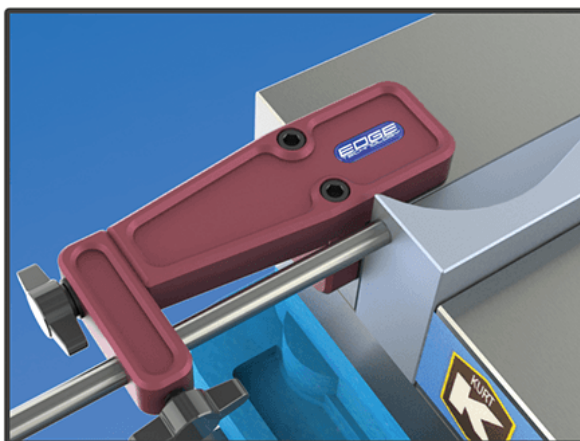

STEP 4

- OPEN THE VISE AND INSTALL THE OTHER SOFT JAW ON THE STATIONARY SIDE OF THE VISE. MAKE SURE THE SOFT JAW CONTACTS THE STOP ROD BEFORE TIGHTENING THE JAW SCREWS.
- REMOVE THE SOFT JAW LOCATOR.

